



Connectivity for Accelerated Growth



What Gary can expect from the NICTD  
Double Track project

# Agenda

1. Who is doing the project?
2. What will it look like?
3. When will it start/finish?
4. How will we get there from here?
5. Where do I get more information?

# Who is doing the project?

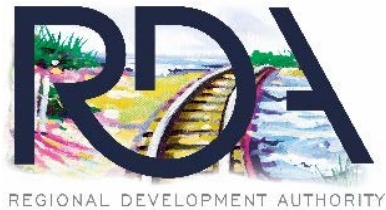

# What will it look like?

---

## What is it?

- Major capital investment to double track 16 miles of our railroad between Gary and Michigan City



# DECREASED TRAVEL TIME

*Times shown are to Millennium Station*



## BEFORE

Michigan City: 1 hour 41 min

Dune Park: 1 hour 21 min

Portage/Ogden Dunes: 1 hr 16 min

Gary (Miller): 1 hour 9 min



## AFTER

Michigan City:

Peak: 1 hr 15 min / Express: 67 min

Dune Park:

Peak: 61 min / Express: 52 min

Portage / Ogden Dunes:

Peak: 55 min / Express: 47 min

Gary (Miller):

Peak: 50 min / Express: 43 min

*Future times are estimated based on current modeling estimates; may change based on final engineering*







# 5 Construction Packages for DT Project

- Package 1- Main Contract: Track, Systems, Platforms, Structures, Roadways
- Package 2- Michigan City Garage, Station & Retail
- Package 3- Gary (Miller) Station & East Parking Lot
- Package 4- Ogden Dunes South Parking & Stagecoach Road
- Package 5- Dune Park East Parking Lot Extension

## What is included?

- New stations at Gary (Miller) and Michigan City
- High-level platforms at Gary (Miller), (2), Ogden Dunes/Portage (1) and Michigan City (2)
- New and expanded parking lots
- 4 RR bridges, 20 culverts, 3 retaining walls
- New track including setout tracks at Miller
- Roadway and Pedestrian grade crossings
- Municipal Utility Relocations



Existing Miller Platform



Double Track Platform

# Gary (Miller) Station

## TRAVEL TIME TO MILLENNIUM STATION

TODAY: 1 hour 9 min

AFTER DOUBLE TRACK: Peak: 50 min / Express: 43 min



# Gary (Miller) Station – Site Plan

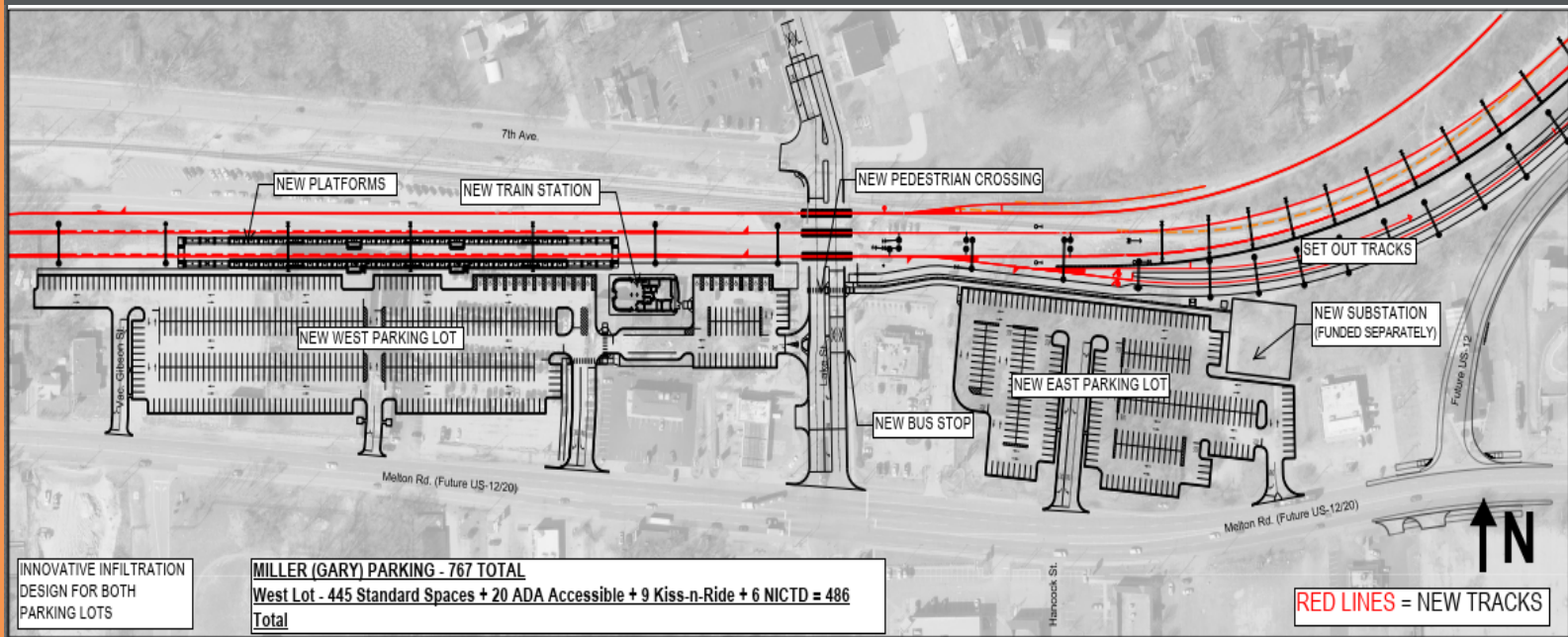

INNOVATIVE INFILTRATION DESIGN FOR BOTH PARKING LOTS

**MILLER (GARY) PARKING - 767 TOTAL**  
**West Lot - 445 Standard Spaces + 20 ADA Accessible + 9 Kiss-n-Ride + 6 NICTD = 486**  
**Total**



# Gary (Miller) Station – East Parking Lot

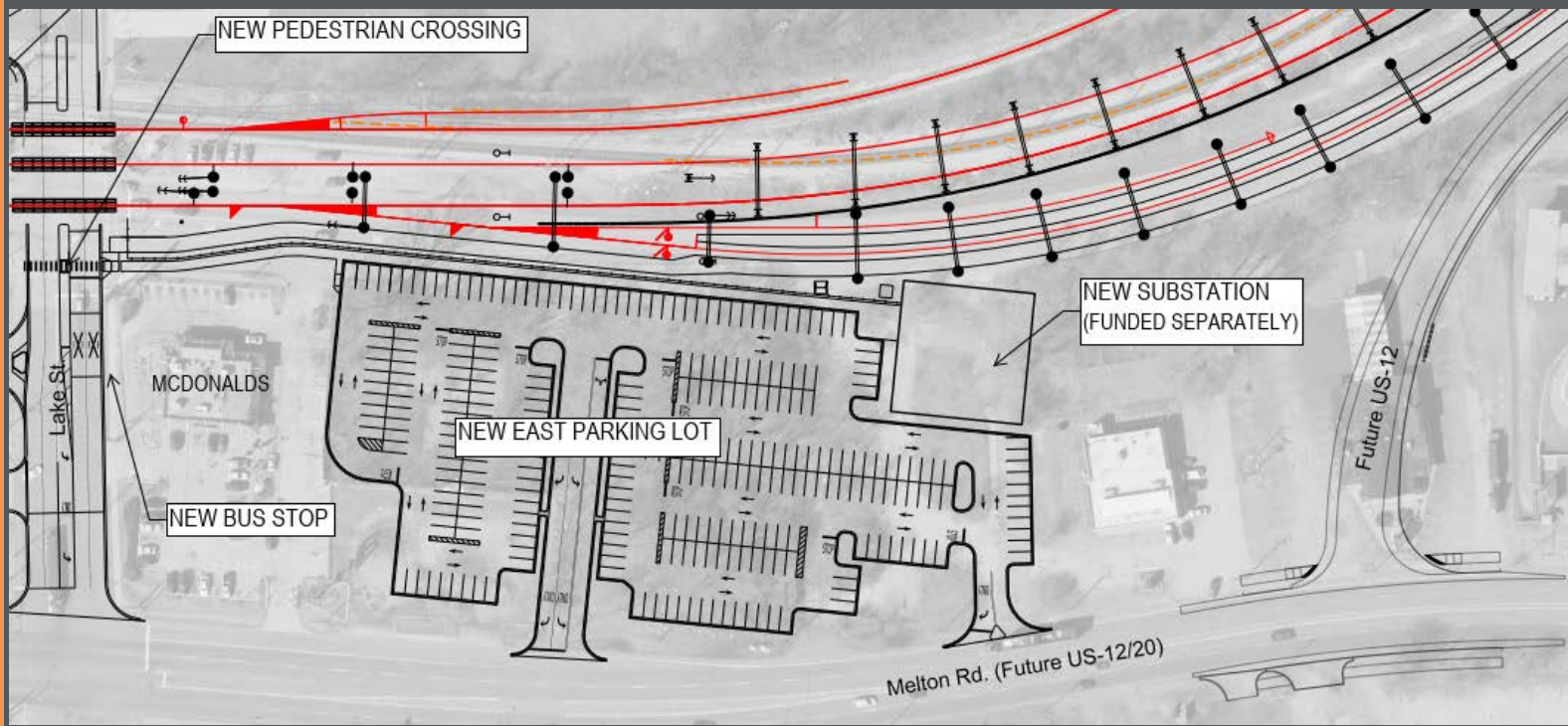



# Gary (Miller) Station – West Lot & Station

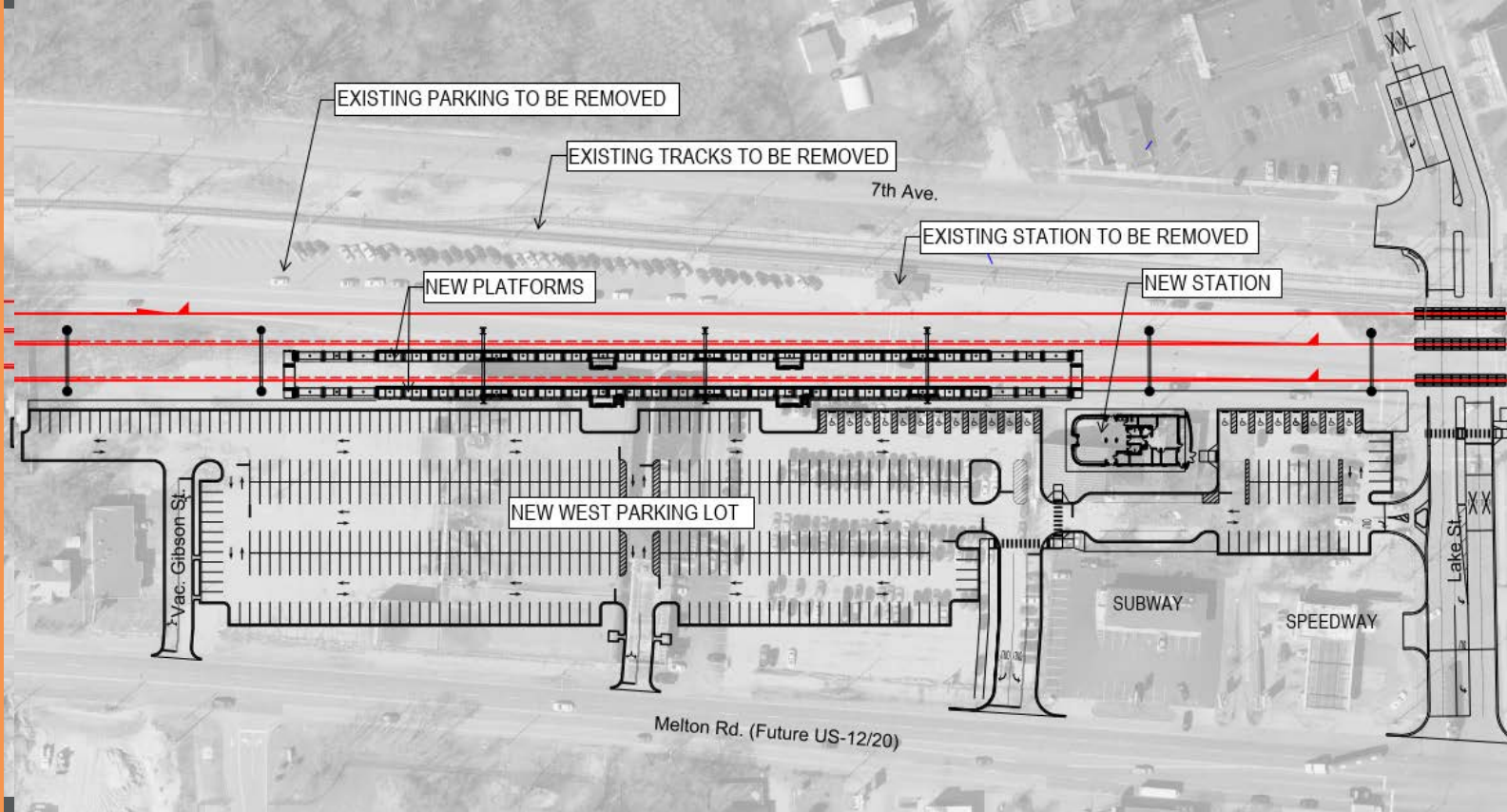

# Gary (Miller) Station – West Lot Sewer Work

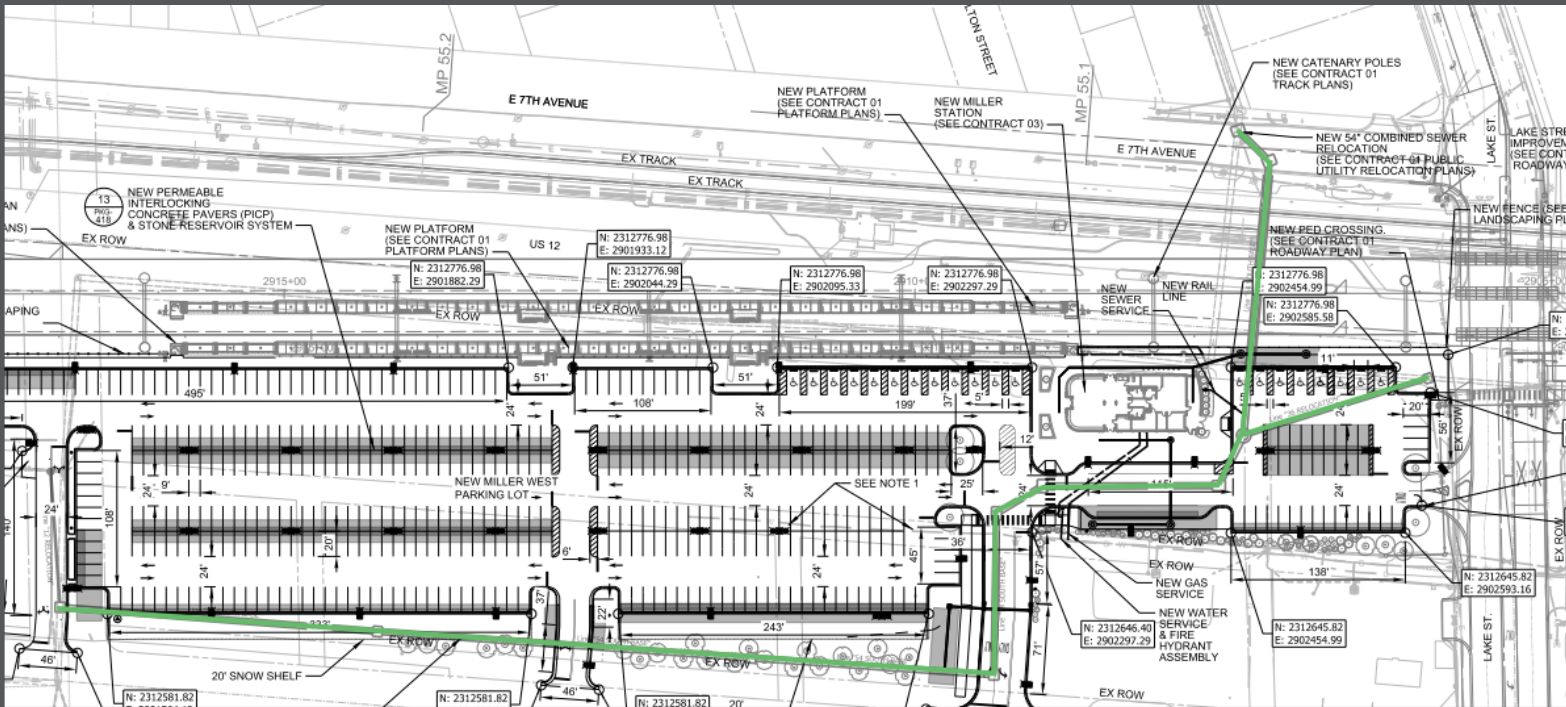

# Gary (Miller) Station

VIEW: Looking westward just to the north of station





# Gary (Miller) Station

VIEW: Looking Northeast at southwest corner of station



# Gary (Miller) Station



VIEW: LOOKING  
west from Lake Street

# Gary (Miller) Station Floor Plan

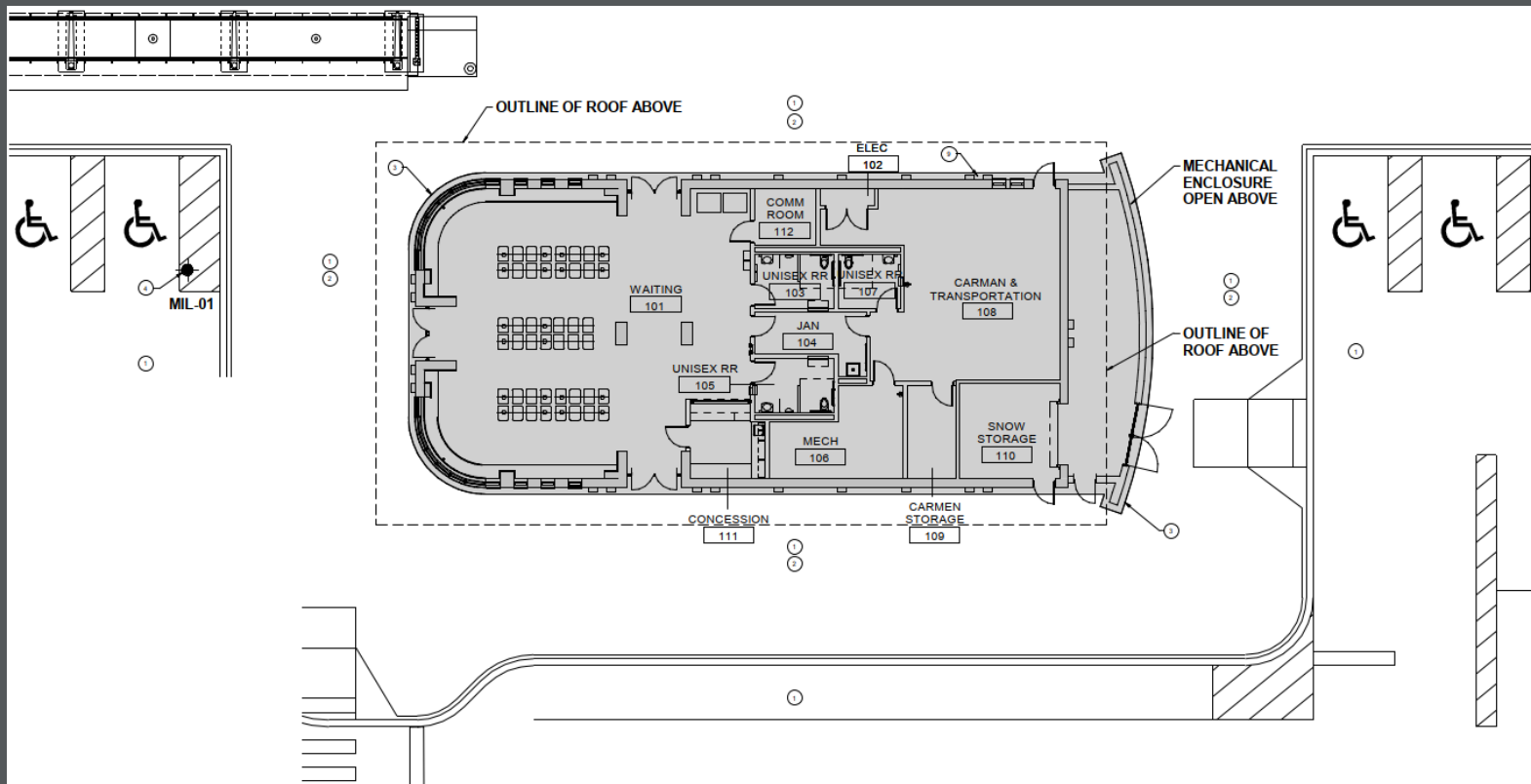



# INDOT Detour Plan for US 20 Connector Project

## Closure of US 12 at the current US 20 intersection, west of Clay Street

- Traffic will be detoured along US 20 and SR 249
- Access to local residences and businesses will be maintained utilizing Clay Street

## Partial closures along US 20 and Lake Street

- A minimum of one lane will be maintained in each direction during construction

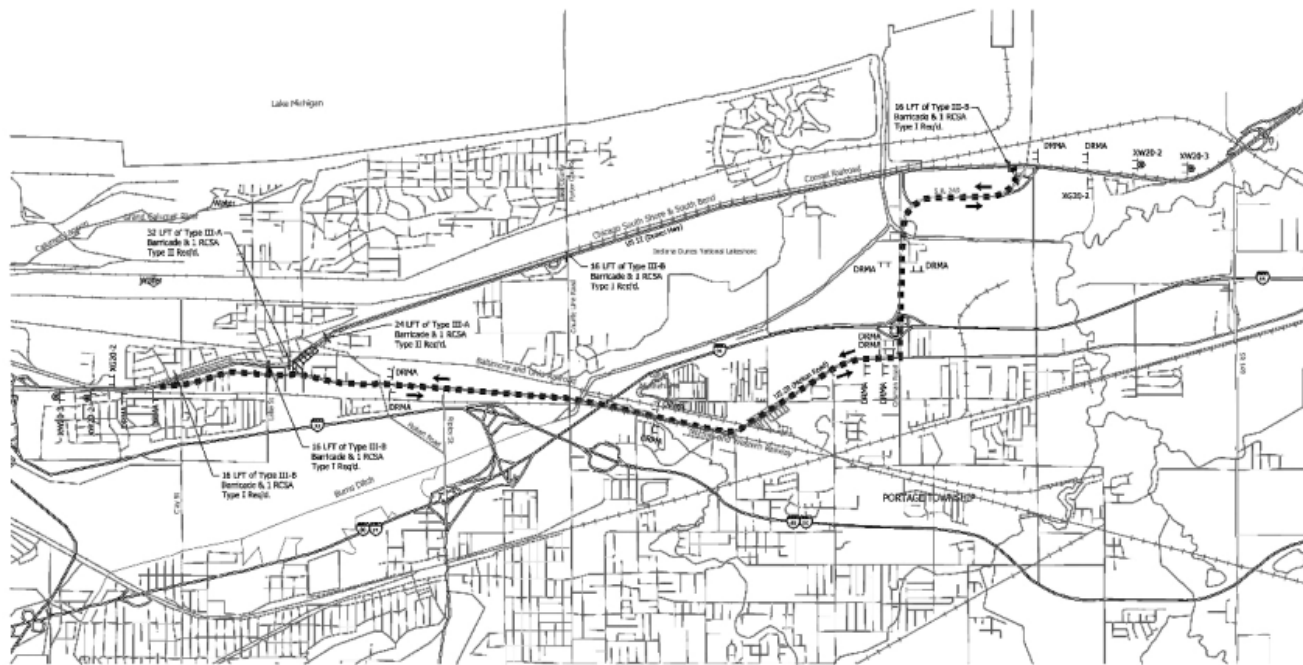



# Gary (Miller) – Clay St. & 7<sup>th</sup> Ave. Grade Crossing Detours

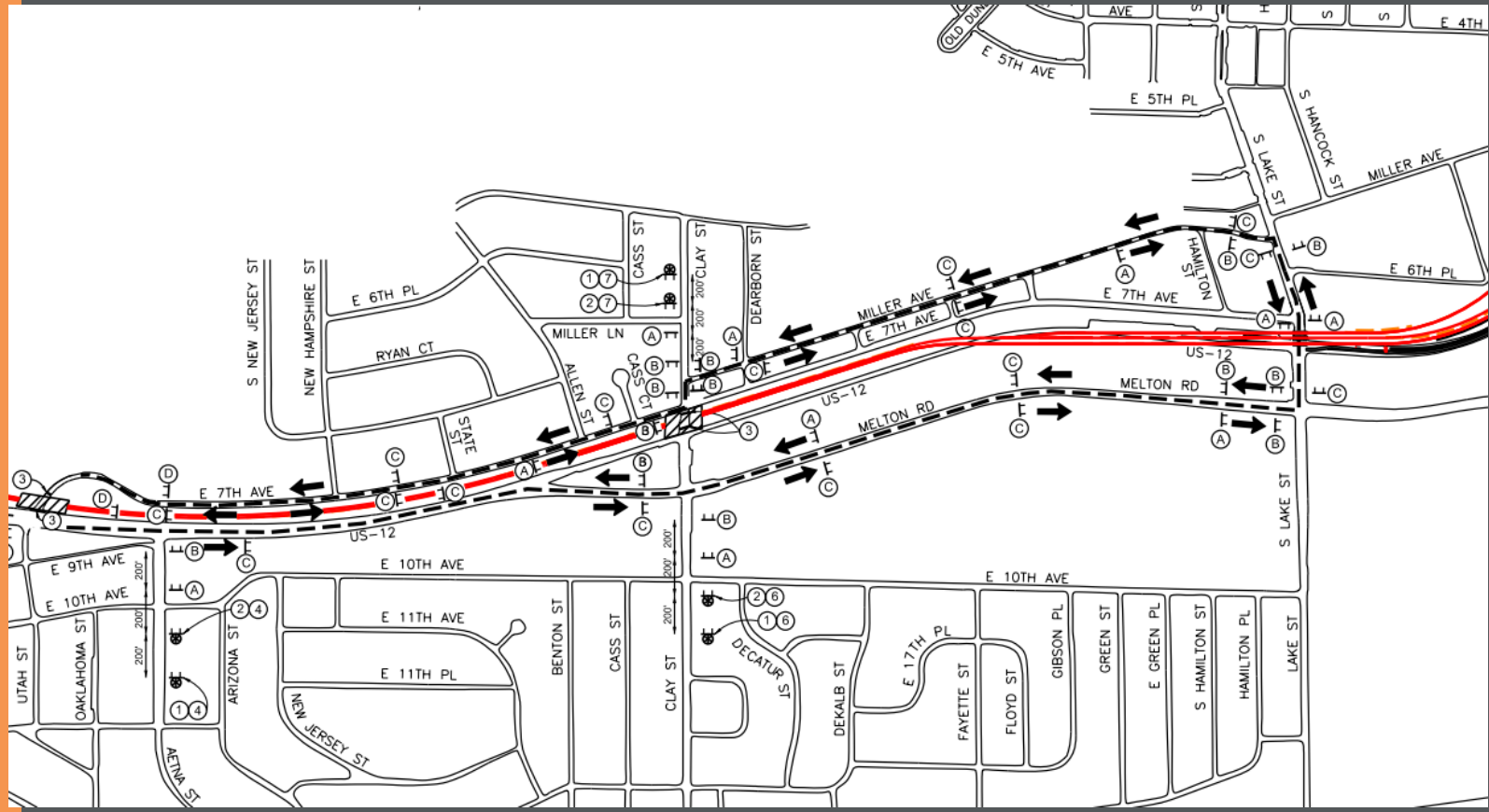

# Gary (Miller) - Construction Phase 1

- Major Work Elements Anticipated:
  - INDOT to reconstruct, re-align US 12
  - Relocate 54" Storm Sewer West of Lake St.
  - Construct East Parking Lot
  
- Anticipated Impacts:
  - Existing US 12 closed at project site
  - Limited closure on 7<sup>th</sup> Street west of Lake St. (1 - 2 weeks expected)

## Gary (Miller) - Construction Phase 2

- Major Work Elements Anticipated:
  - Construct portion of new west parking lot
  - Begin station and platform construction
  - Begin track construction east & west of Lake Street
  - Open east parking lot
  
- Anticipated Impacts:
  - Weekend station closures
  - Close existing parking lot

# Gary (Miller) - Construction Phase 3

- Major Work Elements Anticipated:
  - Complete parking lot west of Lake Street
  - Install grade crossings for new tracks across Lake Street
  - Complete new south track and platform
- Anticipated Impacts:
  - Lake Street Full Closure (14 -21 days expected; detours available)



# Gary (Miller) - Construction Phase 4

- Major Work Elements Anticipated:
  - Open new south track, high-level platform (close existing station)
  - Construct new north track and platform
  - Complete new station & west parking lot
  - Construct new freight track and crossing at Lake Street
  - Remove existing tracks
- Anticipated Impacts:
  - Intermittent lane closures
  - Lake Street Full Closure (14 – 21 days expected; detours available)
  - Parking area north of Lake Street closed

# When will it start/finish?

---

# Miller Station – Latest Schedule

- FTA Approves Final Federal Grant Commitment: 01/07/21
- Advertise Projects 1 & 3 for Construction Bidding: 01/07/21
- Project 1 Construction NTP 1: 06/11/21
- Project 1 Construction NTP 2: 07/30/21
- Project 3 Construction NTP 1: 07/30/21
- Project 3 Construction NTP 2: 09/24/21
- Project 1 Substantial Completion: 05/10/23
- Project 3 Substantial Completion: 04/05/23

How will we get there from  
here?

---

# Next Steps

- Contractor Procurement Phase
- NIPSCO Utility Relocates
- Building Demolition
- Media campaign about construction and safety

# Where do I get more information?

---





# Project Website

www.doubletrack-nwi.com

Select Language | ▼



[ABOUT](#) [PROPERTY IMPACT](#) [NEXT STEPS](#) [DOCS](#) [NEWS](#) [CONTACT](#)

[✉ Sign Up for Latest News and Project Updates](#)



**CONNECTIVITY**  
FOR ACCELERATED GROWTH

# Project Website

New Construction Page  
for the latest updates

www.doubletrack-nwi.com/docs

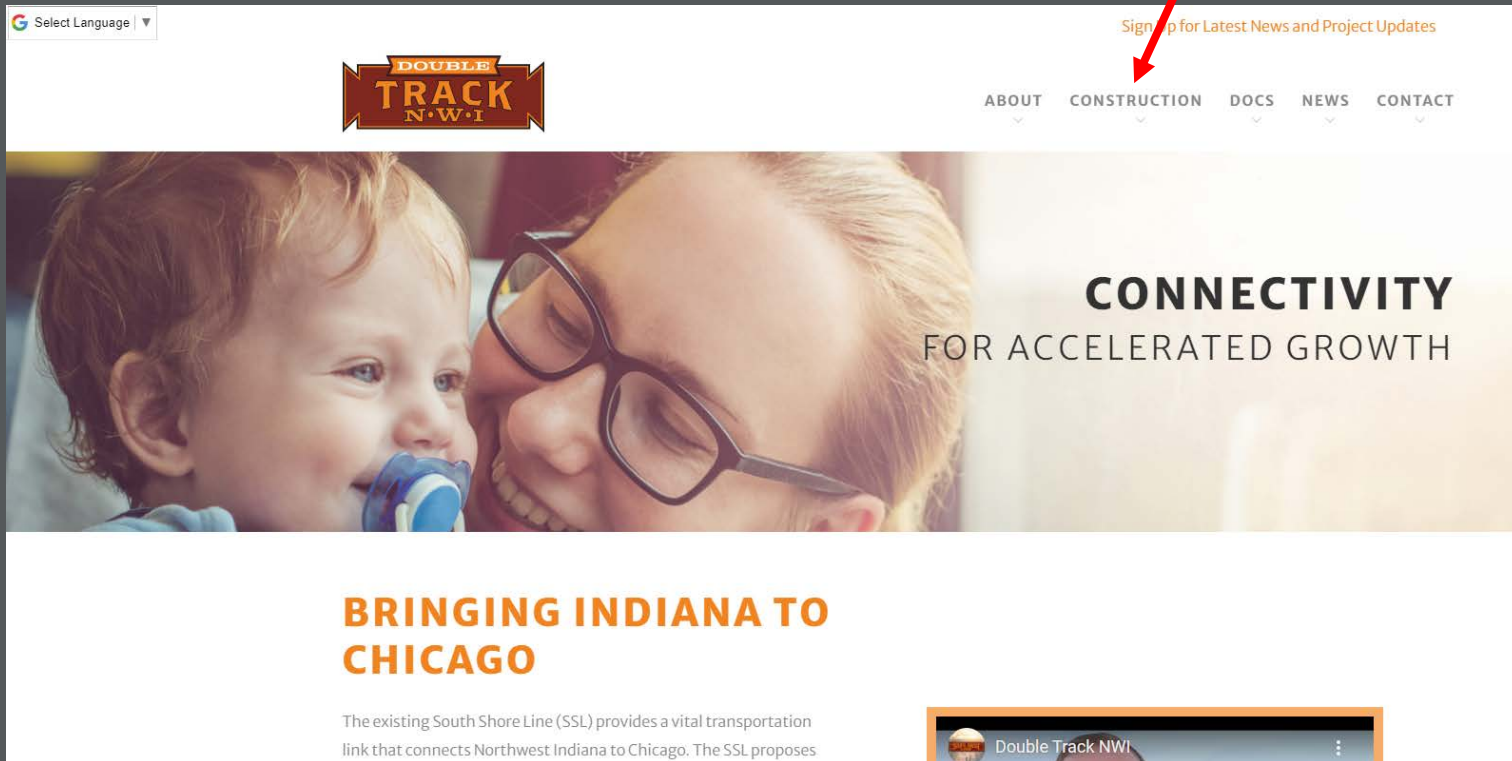

Select Language ▼

Sign up for Latest News and Project Updates

**DOUBLE  
TRACK  
N·W·I**

ABOUT CONSTRUCTION DOCS NEWS CONTACT



**CONNECTIVITY  
FOR ACCELERATED GROWTH**

**BRINGING INDIANA TO  
CHICAGO**

The existing South Shore Line (SSL) provides a vital transportation link that connects Northwest Indiana to Chicago. The SSL proposes

Double Track N·W·I

# Project Website

- New **Construction Information** section was added to the website. By spring, it will be populated with:
  - Look-ahead Schedule of Work by geographic area
  - What residents and businesses need to know about temporary road closures/detours and pedestrian route changes, including ADA
- A formal Construction Outreach Plan will be developed with municipalities, NICTD, and our Construction Management firm, WSP
- eNews email list, press releases, social media



# Wayfinding Signage

- Wayfinding signage will be added



# Fire Life Safety & Security Committee

- Emergency Responders included from Gary to Michigan City
- Gary Police & Fire Departments Represented
- NICTD will require training for all construction workers
- Required to carry photo ID badges on their person when on property
- Construction sites will be required to be secured when not in use



# Fire Life Safety & Security Committee

- Emergency Responders included from Gary to Michigan City
- Gary Police & Fire Departments Represented



New safety element – crossing across tracks at second platform - that will require education (Miller Station example)

# Utility Relocation

- Gary municipal utility relocations designed and constructed by NICTD Double Track Project:
  - Sanitary sewers
  
- Private utility relocations
  - NIPSCO gas mains
  - NIPSCO power lines
  - Other communication utilities

# REAL ESTATE & DEMOLITION

---



# Property Acquisitions & Relocations

For Double Track Acquisition Maps, go to:

<https://www.doubletrack-nwi.com/property-impact/real-estate>

Real Estate Hotline: 800-382-5206

Federal policies require that any property acquisitions and/or relocations follow the *Uniform Relocation Assistance & Real Property Acquisition Policies Act of 1970 (Code of Federal Regulations, Title 49, Part 24)*

[www.transit.dot.gov/funding/grant-programs/capital-investments/general-acquisition-and-relocation-information](http://www.transit.dot.gov/funding/grant-programs/capital-investments/general-acquisition-and-relocation-information)

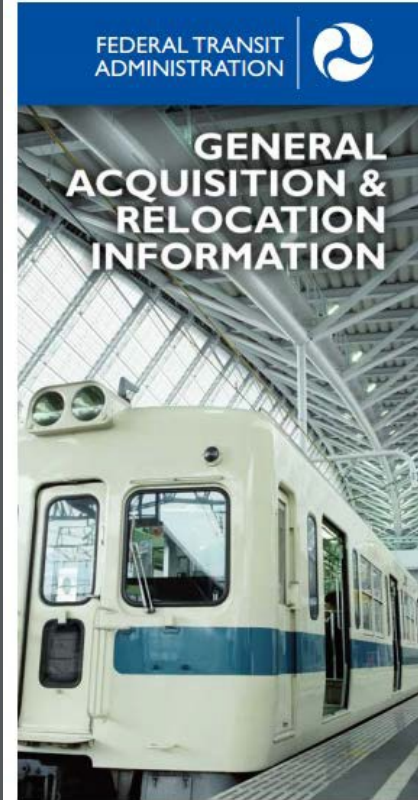

SEE THE BACK PANEL OF THIS BROCHURE FOR INFORMATION ON CONTACTING YOUR LOCAL AGENCY.

# Property Acquisition & Demolition

Demolition Segment	Estimated Start Date* (Sept 2020 schedule)	Estimated Completion*
Michigan City: Maple to Washington	Early Spring 2021	July 2021
Michigan City : Tennessee St to County Line Rd	Early Spring 2021	July 2021
Ogden Dunes	Early Spring 2021	July 2021
Miller	Early Spring 2021	July 2021

244 parcels to be acquired or easement secured  
Acquisition is underway now / relocations to follow

- 58 Residential Structures to be Demolished
  - Michigan City: 55
  - Gary & Ogden Dunes: 3
- 11 Commercial Structures to be Demolished
  - Michigan City: 5
  - Gary & Ogden Dunes: 6

# Demolition

- Beam, Longest & Neff (BLN) – NICTD’s real estate firm – overseeing C Lee, the demolition contractor for Gary
- Upon NICTD possession of property, sites will be secured and boarded up within 48 hours
- No Trespassing Signs will be posted
- Asbestos, lead, other contamination will be addressed per regulations
- Utility disconnects managed by BLN
- Demolition estimated to occur 1.5 to 3 months post board-up
- BLN/demo contractor will formally notify municipalities and NICTD of closures, access changes during demolition



# QUESTIONS?

PROJECT WEBSITE:

[www.doubletrack-nwi.com](http://www.doubletrack-nwi.com)

GENERAL PROJECT HOTLINE:

219-850-4457

[doubletracknwi@nicted.com](mailto:doubletracknwi@nicted.com)



- Website: <http://www.doubletrack-nwi.com/>
- Email questions anytime to: [doubletracknwi@nictd.com](mailto:doubletracknwi@nictd.com)
- Real Estate Hotline: 800-382-5206
- Facebook: Double Track Northwest Indiana
- Mail: South Shore Line  
Attn: Double Track NWI  
33 East U.S. Highway 12  
Chesterton, IN 46304